

Container Disassembly

1. Remove shipping bands from the container. Remove the top cover.

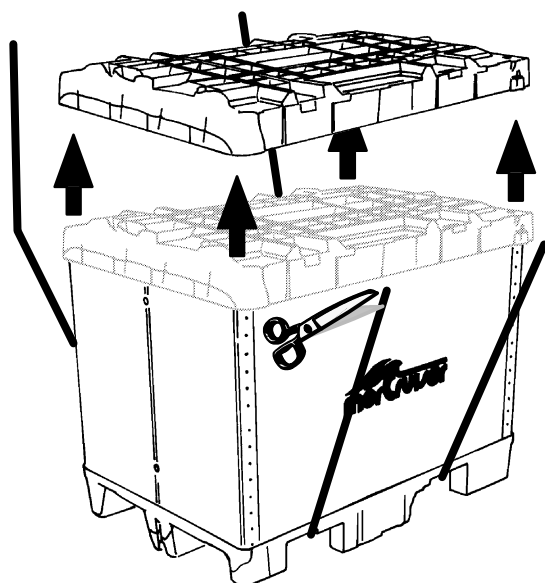

74618

2. Remove the four metal corner posts and place in underside of top cover. Turn latches to lock posts in position.

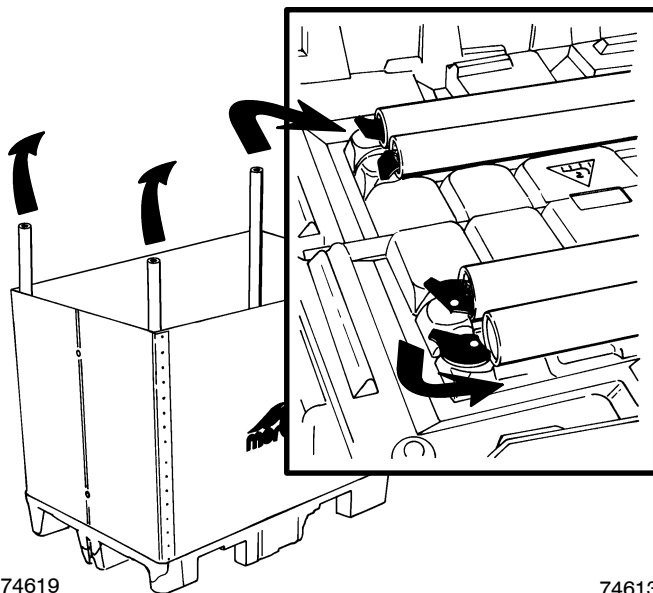

74619

74613

3. Remove the sides of the container and fold flat as shown. Place aside temporarily.

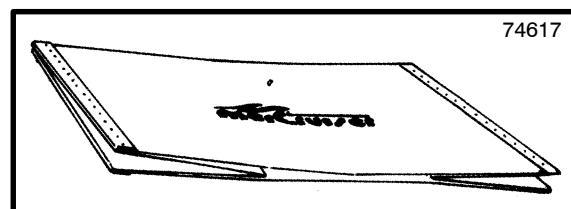

74617

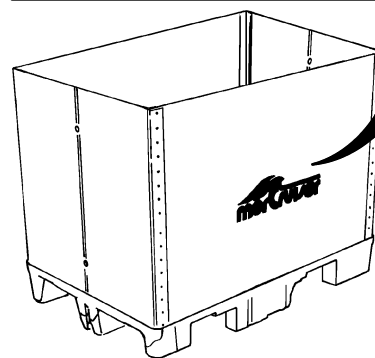

74621

4. Support engine with a hoist using a suitable sling attached to engine lifting eyes. (Refer to product "Installation Manual" for location of lifting eyes.)
5. Remove clips retaining port and starboard engine mounts to upright pins on brackets.

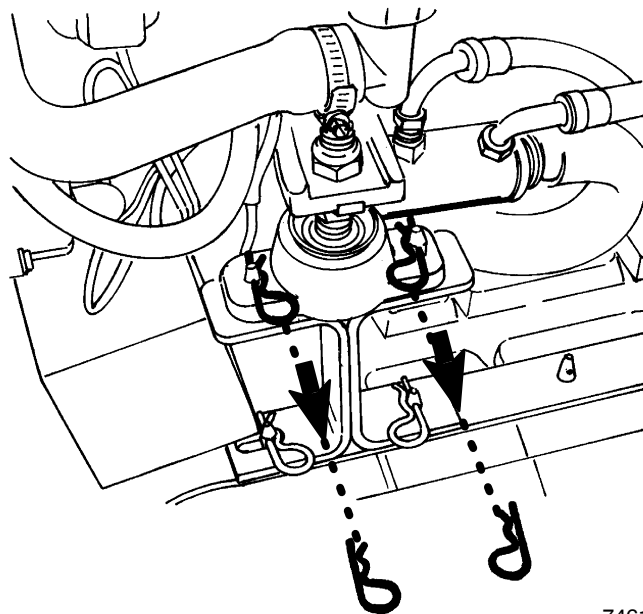

74614

6. As appropriate, remove stern drive components and engine from container.

NOTICE

Containers are the property of Mercury Marine. Failure to return containers on a timely basis will result in your obligation to pay \$95.00 for each container not returned.

Assembly Of Container For Return

1. Remove clips securing brackets to upright pins on container base. Put clips in pin holes. Place brackets in appropriate slots of container base as shown.

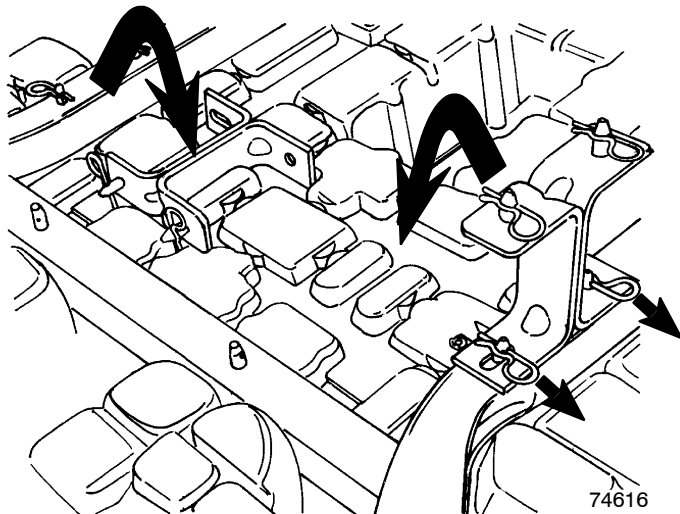

2. Position folded sides of container on base. Place top cover over base assembly. Stack no more than four complete assemblies together and band for shipping.

NOTE: White painted ends of container are matched when properly assembled.

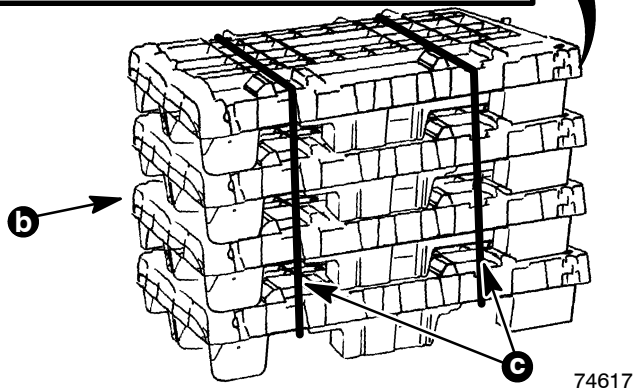
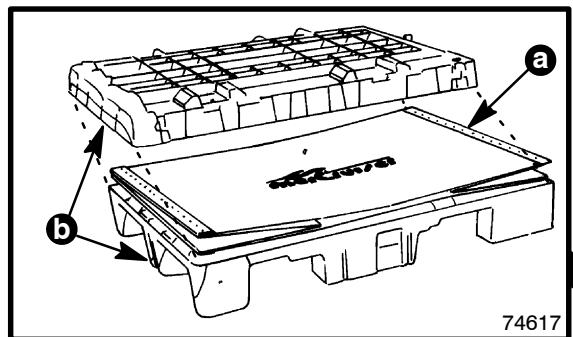

- a - Folded Container Sides
- b - White Ends
- c - Shipping Bands

3. As needed, stack as many as sixteen cradles together. Place three or more stacks inside an empty *un-collapsed* container. Band for shipment.

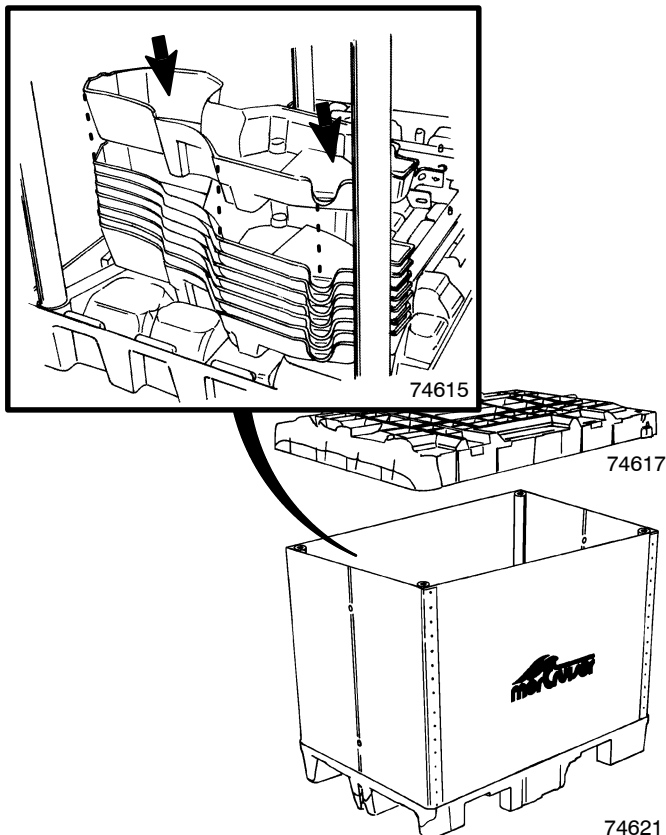

4. When you have containers ready for return, follow these instructions :
 - a. Call 1-800-872-5225.
 - b. Identify yourself, your company and address.
 - c. Tell them that the purpose of your call is - "To return containers to MerCruiser in Stillwater, Oklahoma."

Returns should be shipped care of :

FedEx Supply Chain Services
303 East Harned
Stillwater, Oklahoma 74075

- d. Tell them how many containers are ready to be returned.
- e. Also, leave your phone number so that if any further information would be needed the shipper may contact you.

NOTICE

Containers are the property of Mercury Marine. Failure to return containers on a timely basis will result in your obligation to pay \$95.00 for each container not returned.

5. Please contact MerCruiser Distribution at 405-743-7546 if there are any questions.