

Maintenance Items

Select Yamaha Item # to
Open with the PPT
ONLINE STORE



Return to PPT
Website

Water Pump Housings

General
Information

Rigging Estimate
Guide (Diagrams)

Rigging
Components

Electrical
Components

Engine
Accessories

Propellers

Maintenance
Items

Oils
& Lubes

Detailing &
Trailer Supplies

Accessories
& Apparel

Generators
& Accessories

4 Stroke Application Part Number

F2.5	69M-G4311-00-00
F4 (~06/2008)	68D-G4311-01-00
F4 (09/2009~)	6BX-44311-00-00
F8,T8 (01~) F6 (~06/2008)	63V-44301-00-00
F9.9, T9.9 (~04)	682-44300-01-00
F9.9/T9.9 (05~)	63V-44301-00-00
F15 (98~)	63V-44301-00-00
F15C, F20	6AH-44311-00-00
F25	61N-44311-01-00
T25, F30, F40 (00~)	66T-44311-00-00
F40 (99)	63D-44311-00-00
F50, F60	63D-44311-00-00
T50, T60	6H3-44311-00-00
F70	6CJ-44311-00-00
F75, F80, F90, F100	67F-44311-01-00
F115, New F115B, F150, F200, F225	61A-44311-01-00
VF200, VF225, VF250	61A-44311-01-00
F225, F250, F300 (4.2L)	6CE-44311-01-00
F250, F250B	61A-44311-01-00
F300, F350 (V8)	6AW-44311-01-00

2 Stroke Application Part Number

2	99999-02129-00
3	6L5-44311-00-00
4,5	6E0-44311-00-00
6,8	6N0-G4311-00-00
9.9/15 (96)	63V-44301-00-00
9.9/15 (~95)	682-44300-01-00
20,25 Two Cyl	6L2-44311-00-00
25,30 Three Cyl	6J8-44311-00-00
C25	689-44311-03-00
C30 (93~97)	61N-44311-01-00
C30 (~92)	689-44311-03-00
40, 50, P50 (~94)	6J8-44311-00-00
40, C40, P40, 50, C50, P50 (95~)	63D-44311-00-00
E48, C55	663-44311-02-00
60, C60, P60, E60 (~03)	6H3-44311-00-00
60,70 (04~), C75, E75, P75, 90	688-44311-01-00
C85 (92~95)	688-44311-01-00
C85 (89~91,96~97)	67F-44311-00-00
115, C115, 130 (~92)	61A-44311-01-00
115, B115, C115, P115, S115 (93~)	61A-44311-01-00
130, S130 (93~)	61A-44311-01-00
150, P150, 175, 200, 225 (~91)	61A-44311-01-00
V150, VX150 (92~)	61A-44311-01-00
150, C150, D150, DX150 (92~)	61A-44311-01-00
P150, PX150, P175, P200 (92~)	61A-44311-01-00
S150, SX150, S200, SX200	61A-44311-01-00
S225, SX225, S250, SX250	61A-44311-01-00
175, 200, 225, 250	61A-44311-01-00
V200, VX200, V225	61A-44311-01-00
VX225, V250, VX250	61A-44311-01-00
VZ150, VZ175, VZ200	61A-44311-01-00
VZ225, VZ250, VZ300	61A-44311-01-00
Z150, Z175, Z200, Z250, Z300	61A-44311-01-00

Jet Drive Application Part Number

F40	67C-44311-10-00
F50/F60	62Y-44311-10-00
F75/F80/F90/F100	67F-44311-11-00
F115 (Requires both part numbers)	61A-44311-01-00 6E5-44322-00-00

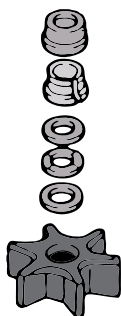

Anti-Knock Washers

Required when changing a water pump on engines utilizing anti-knock washers.

Collar	61A-45527-00-00
Spacer	61A-45538-00-00
Plate Washer	90201-22M01-00
Wave Washer	90206-22M19-00

Maintenance Items

T8, T9.9 (04/2007~) - 69G-W0078-00-00

Kit Includes:

Qty	Description	Part #
1	Insert, Cartridge	63V443220000
1	Damper, Water Seal 2	68T443660000
1	Impeller	63V443520100
1	Key, Woodruff	664443380000
1	O-Ring	932104470400
1	Outer Plate, Cartridge	68T443230000
4	Bolt	970950804500

F9.9, T9.9, FT9.9 (~96) - 682-W0078-A1-00

Kit Includes:

Qty	Description	Part #
2	Gasket, Water Pump	68244315A000
1	Insert, Cartridge	682443220000
1	Outer Plate, Cartridge	682443230000
1	Damper, Water Seal 1	682443650000
1	Key, Woodruff	902800302400
4	Bolt	970950604000
1	Impeller	682443520300

F9.9, T9.9, FT9.9 (~96), F9.9, T9.9 (04~04/2005), FT9.9 (04~04/2005) - 682-W0078-A3-00

Kit Includes:

Qty	Description	Part #
1	Damper, Water Seal 1	682443650000
4	Bolt	970800604500
1	Insert, Cartridge	682443220000
1	Impeller	682443520300
2	Gasket, Water Pump	68244315A000
1	Outer Plate, Cartridge	682443230000
1	Key, Woodruff	902800302400

F9.9-2, T9.9-2, F15 - 63V-W0078-01-00

Kit Includes:

Qty	Description	Part #
1	Damper, Water Seal 2	647443660000
4	Bolt	970950804500
1	Insert, Cartridge	63V443220000
1	Impeller	63V443520100
1	Outer Plate, Cartridge	63V443230000
1	Key, Woodruff	664443380000

4-Stroke Water Pump Repair Kits

F2.5 - 69M-WG078-00-00

Kit Includes:

Qty	Description	Part #
1	O-Ring	9321033M85
1	Insert Cartridge	6L5443220000
1	Outer Plate Cartridge	69MG43230000
1	Damper, Water Seal 2	6E0443660000
1	Impeller	6L5443520000
4	Bolt	970950604000
2	Pin, Dowel	936041808000
2	Plate	69MG43280000

F4, F6 (09/2009~) - 6BX-WG078-00-00

Kit Includes:

Qty	Description	Part #
1	Housing, Water Pump	6BX443110000
1	Gasket, Water Pump	6BXG43150100
1	Insert, Cartridge	6BX443220000
1	Outer Plate, Cartridge	6BX443230000
1	Damper, Water Seal 2	67D443660000
1	Impeller	6E0443520000
4	Bolt	970800604500
2	Pin, Dowel	936041808000

F4 (~06/2008) - 68D-WG078-00-00

Kit Includes:

Qty	Description	Part #
1	Housing, Water Pump	68DG43110100
1	Gasket, Water Pump	6BXG43150100
1	Insert Cartridge	6E0443220200
1	Outer Plate, Cartridge	6E0443230000
1	Damper, Water Seal 2	67D443660000
1	Impeller	6E0443520000
4	Bolt	970800604500
2	Pin, Dowel	936041808000

F6, F8 (~06/2008) - 68T-W0078-00-00

Kit Includes:

Qty	Description	Part #
1	Insert, Cartridge	63V443220000
1	Damper, Water Seal 2	68T443660000
1	Impeller	68T443520000
1	Key, Woodruff	664443380000
1	O-Ring	932104470400
1	Outer Plate, Cartridge	68T443230000
4	Bolt	970950804500

General Information

Rigging Estimate Guide (Diagrams)

Rigging Components

Electrical Components

Engine Accessories

Propellers

Maintenance Items

Oils & Lubes

Detailing & Trailer Supplies

Accessories & Apparel

Generators & Accessories

Maintenance Items

General Information

F15C, F20 - 6AH-W0078-00-00

Kit Includes:

Qty	Description	Part #
1	Housing, Water Pump	6Ah443110000
1	Insert, Cartridge	63V443220000
1	Damper, Water Seal	6L2443670000
1	Impeller	63V443520100
1	Key, Woodruff	664443380000
1	O-Ring	932104904600
1	Outer Plate, Cartridge	68T443230000
2	Pin, Dowel	9360412M0700
4	Bolt	970950804500
2	Plate	63V443280100

Rigging Estimate Guide (Diagrams)

Rigging Components

Electrical Components

Engine Accessories

Propellers

Maintenance Items

Oils & Lubes

Detailing & Trailer Supplies

Accessories & Apparel

Generators & Accessories

F25 - 61N-W0078-11-00

Kit Includes:

Qty	Description	Part #
1	Insert, Cartridge	63V443220000
1	Damper, Water Seal 3	6L2443670000
1	Impeller	63V443520100
1	Key, Woodruff	664443380000
1	O-Ring	932104904600
1	Outer Plate, Cartridge	68T443230000
2	Pin, Dowel	9360410M0300
4	Bolt	970950804500
2	Plate	63V443280100

T25, F30, F40 (00~2009) - 66T-W0078-00-00

Kit Includes:

Qty	Description	Part #
1	Insert, Cartridge	63D443220000
1	Outer Plate, Cartridge	66T443230000
1	O-Ring	9321059MG7
1	Gasket, Water Pump	63D443160000
1	Key, Woodruff	9028003M0300
1	Impeller	6H4443520200
4	Bolt, With Washer	9011908M1500
1	Damper, Water Seal 2	663443660000
1	Pump Housing Cover	63D443120000

F40 (99), F50 (97~), F60 (02~) - 63D-W0078-01-00

Kit Includes:

Qty	Description	Part #
1	Insert, Cartridge	63D443220000
1	Impeller	6H3443520000
1	Cover, Water Pump Housing	63D443120000
1	Outer Plate, Cartridge	63D443230000
1	O-Ring	9321059MG700
1	Gasket, Water Pump	63D443160000
4	Bolt, With Washer	9011908M1500
1	Damper, Water Seal 2	663443660000
1	Key, Woodruff	902800302400

F40 (2010~) - 6BG-W0078-00-00

Kit Includes:

Qty	Description	Part #
1	Pump Housing Cover	63D-44312-00-00
1	Gasket, Water Pump	63D-44316-00-00
1	Insert Cartridge	63D-44322-00-00
1	Outer Plate, Cartridge	63D-44323-00-00
1	Damper, Water Seal 2	663-44366-00-00
1	Impeller	6H4-44352-02-00
4	Bolt, With Washer	90119-08M15-00
1	Key, Woodruff	90280-03M03-00
1	O-Ring	93210-59MG7-00

Maintenance Items

F75, F80, F90, F100 - 67F-W0078-00-00

Kit Includes:

Qty	Description	Part #
1	Insert, Cartridge	67F443220000
1	Impeller	67F443520000
1	Gasket, Water Pump	68844315A000
1	Outer Plate, Cartridge	67F443230000
1	Gasket, Cartridge	68844324A000
1	Gasket, Water Pump	68844316A000
1	O-Ring	932104604400
2	Bolt, With Washer	9011908M8700
2	Bolt, With Washer	9011908M1300
1	Key, Woodruff	9028004M0400

F115 (00~01) - 6N6-W0078-02-00

Kit Includes:

Qty	Description	Part #
1	Insert, Cartridge	61A443220200
1	O-Ring	9321086M3800
1	O-Ring	9321037M6700
1	Impeller	6E5443520100
1	Outer Plate, Cartridge	6E5443230000
1	Gasket, Water Pump	6E544315A000
2	Pin, Dowel	936061201900
4	Bolt, With Washer	9011908M1400
1	Key, Woodruff	9028004M0500
1	Key, Woodruff	9028004M0400

F115 (02~) - 68V-W0078-00-00

Kit Includes:

Qty	Description	Part #
1	Insert, Cartridge	61A443220200
1	O-Ring	9321086M3800
1	O-Ring	9321037M6700
1	Impeller	6E5443520100
1	Outer Plate, Cartridge	68V443230000
1	Gasket, Water Pump	6E544315A000
2	Pin, Dowel	936061201900
4	Bolt, With Washer	9011908M1400
1	Key, Woodruff	9028004M0500

F50, T50 (96) - 6H3-W0078-A0-00

Kit Includes:

Qty	Description	Part #
1	Gasket, Water Pump	6H344315A000
1	Outer Plate, Cartridge	6H3443230000
1	Gasket, Cartridge	6H344324A000
1	Impeller	6H3443520000
1	Insert, Cartridge	663443220000
1	Gasket, Water Pump	68844316A000
1	Key, Woodruff	9028003M0300
1	O-Ring	932104604400
2	Bolt	970800805500
2	Bolt	970800804500

T50, T60 (97~) - 6H3-W0078-02-00

Kit Includes:

Qty	Description	Part #
1	Insert, Cartridge	663443220000
1	Impeller	6H3443520000
1	Gasket, Water Pump	6H344315A000
1	Outer Plate, Cartridge	6H3443230000
1	Gasket, Cartridge	6H344324A000
1	Gasket, Water Pump	68844316A000
1	O-Ring	932104604400
2	Bolt, With Washer	9011908M1400
2	Bolt, With Washer	9011908M3300
1	Key, Woodruff	9028003M0300

F70 - 6CJ-W0078-00-00

Kit Includes:

Qty	Description	Part #
1	Insert, Cartridge	63D443220000
1	Gasket, Water Pump	6CJ443150000
1	Cover, Pump Housing	63D443120000
1	Damper, Water Seal 2	663443660000
1	Impeller	6H3443520000
1	Key, Woodruff	9028003M0300
2	Oil Seal	931012307000
1	O-Ring	932104604400
1	Gasket, Water Pump	6CJ443160000
1	Outer Plate, Cartridge	6CJ443230000
1	Gasket, Cartridge	6CJ443240000
2	Pin, Dowel	9360410M0300
2	Bolt, With Washer	9011908M3300
2	Bolt, With Washer	9011908M1400

General Information

Rigging Estimate Guide (Diagrams)

Rigging Components

Electrical Components

Engine Accessories

Propellers

Maintenance Items

Oils & Lubes

Detailing & Trailer Supplies

Accessories & Apparel

Generators & Accessories

Maintenance Items

Select Yamaha Item # to Open with the PPT
ONLINE STORE

General Information

F150, F200, F225 - 61A-W0078-A3-00

Kit Includes:

Qty	Description	Part #
1	Insert, Cartridge	61A443220200
1	O-Ring	9321086M3800
1	O-Ring	9321037M6700
1	Impeller	6E5443520100
1	Outer Plate, Cartridge	6G5443230000
1	Gasket, Water Pump	6E544315A000
2	Pin, Dowel	936061201900
4	Bolt, With Washer	9011908M1400
1	Key, Woodruff	9028004M0500

Rigging Estimate Guide (Diagrams)

Rigging Components

Electrical Components

VF200, VF225, VF250 - 6CB-W0078-00-00

Kit Includes:

Qty	Description	Part #
1	Insert, Cartridge	61A443220200
1	O-Ring	9321086M3800
1	O-Ring	9321037M6700
1	Impeller	6E5443520100
1	Key, Woodruff	902800400200
1	Outer Plate, Cartridge	6CB443230000
1	Gasket, Water Pump	6CB443150000
2	Pin, Dowel	936061201900
4	Bolt, With Washer	9011908M1400

Engine Accessories

Propellers

Maintenance Items

Oils & Lubes

F225, F250, F300 (4.2L) - 6CE-W0078-00-00

Kit Includes:

Qty	Description	Part #
2	Oil Seal	9310422M0700
1	Insert, Cartridge	6AW443220000
1	O-Ring	932109400300
1	O-Ring	9321037M6700
1	Impeller	6CE443520000
1	Key, Woodruff	902800400200
1	Outer Plate, Cartridge	6CE443230000
1	Gasket, Water Pump	6CE443150000
2	Pin, Dowel	936061201900
4	Bolt, With Washer	9011908M1400

Detailing & Trailer Supplies

Accessories & Apparel

Generators & Accessories

F300, F350 (V8) - 6AW-W0078-00-00

Kit Includes:

Qty	Description	Part #
1	Insert, Cartridge	6AW443220000
1	O-Ring	932109400300
1	O-Ring	9321037M6700
1	Impeller	6AW443520000
1	Key	6AW443360000
1	Outer Plate, Cartridge	6AW443230000
1	Gasket, Water Pump	6AW443150000
2	Pin, Dowel	936061201900
4	Bolt, With Washer	9011908M1400

F250, F250B - 6P2-W0078-00-00

Kit Includes:

Qty	Description	Part #
1	Insert, Cartridge	61A443220200
1	O-Ring	9321086M3800
1	O-Ring	9321037M6700
1	Impeller	6E5443520100
1	Outer Plate, Cartridge	6P2443230000
1	Gasket, Water Pump	60X44315A000
2	Pin, Dowel	936061201900
4	Bolt, With Washer	9011908M1400
1	Key, Woodruff	9028004M0500

4, 5 (97~) - 6E0-W0078-A3-00

Kit Includes:

Qty	Description	Part #
1	Housing, Water Pump	6E0443110000
1	Gasket, Water Pump	6E044315A000
1	Insert, Cartridge	6E0443220200
1	Outer Plate, Cartridge	6E0443230000
1	Damper, Water Seal 2	6E0443660000
1	Impeller	6E0443520000
4	Bolt	97080604500
2	Pin Dowel	936041808000

6, 8 (96~) - 6N0-W0078-A0-00

Kit Includes:

Qty	Description	Part #
1	Gasket, Water Pump	6G144315A000
1	Insert, Cartridge	6G1443220000
1	Outer Plate, Cartridge	6G1443230000
1	Damper, Water Seal 2	647443660000
1	Impeller	6G1443520000
2	Plate	6G1443280000
4	Bolt	970800604500

9.9, 15 (~95) - 682-W0078-A1-00

Kit Includes:

Qty	Description	Part #
2	Gasket, Water Pump	68244315A000
1	Insert, Cartridge	682443220000
1	Outer Plate, Cartridge	682443230000
1	Damper, Water Seal 1	682443650000
1	Key, Woodruff	902800302400
4	Bolt	970950604000
1	Impeller	682443520300

9.9, 15 (96~) - 63V-W0078-01-00

Kit Includes:

Qty	Description	Part #
1	Damper, Water Seal 2	647443660000
4	Bolt	970950804500
1	Insert, Cartridge	63V443220000
1	Impeller	63V443520100
1	Outer Plate, Cartridge	63V443230000
1	Key, Woodruff	664443380000

Maintenance Items

2-Stroke Water Pump Repair Kits

2 (89~02) - 6A1-W0078-02-00

Kit Includes:

Qty	Description	Part #
2	Pin, Dowel	936040906800
1	O-Ring	932101912300
2	Oil Seal	9310111M4400
1	Outer Plate, Cartridge	646443230000
1	Impeller	646443520100
1	Insert, Cartridge	646443220000
1	Protector, Oil Seal	6A1443250000
2	Bolt	970950501600

3 (88~02) - 6L5-W0078-00-00

Kit Includes:

Qty	Description	Part #
1	O-Ring	9321033M8500
1	Insert, Cartridge	6L5443220000
1	Outer Plate, Cartridge	6L5443230000
1	Damper, Water Seal 2	6E0443660000
1	Impeller	6L5443520000
4	Bolt	970950604000
2	Pin, Dowel	936041808000
2	Plate	6L5443280000

4, 5 (~96) - 6E0-W0078-A2-00

Kit Includes:

Qty	Description	Part #
1	Housing, Water Pump	6E0443110000
1	Gasket, Water Pump	6E044315A000
1	Insert, Cartridge	6E0443220200
1	Outer Plate, Cartridge	6E0443230000
1	Impeller	6E0443520000
1	Damper, Water Seal 2	6E0443660000
1	Pin, Dowel	936040906600
4	Bolt	970800604500

General Information

Rigging Estimate Guide (Diagrams)

Rigging Components

Electrical Components

Engine Accessories

Propellers

Maintenance Items

Oils & Lubes

Detailing & Trailer Supplies

Accessories & Apparel

Generators & Accessories

Maintenance Items

General Information

20, 25 Two Cylinder - 6L2-W0078-00-00

Kit Includes:

Qty	Description	Part #
1	Outer Plate, Cartridge	6L2443230000
1	O-Ring	932104516100
1	Impeller	6L2443520000
1	Insert, Cartridge	6L2443220000
4	Bolt	970950604000
1	Key, Woodruff	902800302400

Rigging Estimate Guide (Diagrams)

Rigging Components

25, 30 Three Cylinder (96~02) - 6J8-W0078-A2-00

Kit Includes:

Qty	Description	Part #
1	Insert, Cartridge	663443220000
1	Impeller	6H4443520200
1	Gasket, Water Pump	66344315A000
1	Outer Plate, Cartridge	663443230000
1	Gasket, Cartridge	66344324A000
1	Gasket, Water Pump	66344316A000
2	Bolt, With Washer	9011908M1300
2	Bolt, With Washer	9011908M3400

Electrical Components

Engine Accessories

Propellers

C25 (90~97), C30 (90~92) - 689-W0078-A6-00

Kit Includes:

Qty	Description	Part #
1	Damper, Water Seal 1	626443650100
1	Housing, Water Pump	689443110300
3	Bolt, With Washer	9011906M0700
1	Insert, Cartridge	689W44320200
1	Outer Plate, Cartridge	689443230300
1	Gasket, Cartridge	68944324A000
1	Impeller	689443520200
1	Gasket, Water Pump	68944316A000
1	Key, Woodruff	664443380000

Maintenance Items

Oils & Lubes

Detailing & Trailer Supplies

30 (~95) - 6J8-W0078-A1-00

Kit Includes:

Qty	Description	Part #
1	Impeller	6H4443520200
1	Gasket, Water Pump	66344315A000
1	Gasket, Water Pump	66344316A000
1	Insert, Cartridge	663443220000
1	Outer Plate, Cartridge	663443230000
1	Gasket, Cartridge	66344324A000
2	Bolt	970950804000
2	Bolt	970950805000

Accessories & Apparel

Generators & Accessories

C30 (93~97) - 61N-W0078-11-00

Kit Includes:

Qty	Description	Part #
1	Housing, Water Pump	61N443110100
1	Damper, Water Seal 3	6L2443670000
1	Insert, Cartridge	61N443220100
1	Impeller	6H4443520200
1	O-Ring	93104516100
1	Outer Plate, Cartridge	61N443230000
4	Bolt	970950604000
4	Washer	92990660000
1	Key, Woodruff	902800302400

40, 50 P50, (~96) - 63D-W0078-00-00

Kit Includes:

Qty	Description	Part #
1	Gasket, Water Pump	6H344315A000
1	Outer Plate, Cartridge	6H3443230000
1	Gasket, Cartridge	6H344324A000
1	Impeller	6H3443520000
1	Insert, Cartridge	663443220000
1	Gasket, Water Pump	68844316A000
1	Key, Woodruff	9028003M0300
1	O-Ring	932104604400
2	Bolt	970800805500
2	Bolt	970800804500

40, C40 (98~03, P40, 50, C50, P50 (97~)) - 63D-W0078-01-00

Kit Includes:

Qty	Description	Part #
1	Insert, Cartridge	63D443220000
1	Impeller	6H3443520000
1	Cover, Pump Housing	63D443120000
1	Outer Plate, Cartridge	63D443230000
1	O-Ring	9321059MG700
1	Gasket, Water Pump	63D443160000
4	Bolt, With Washer	9011908M1500
1	Damper, Water Seal 2	663443660000
1	Key, Woodruff	902800302400

Maintenance Items

C55 (90~91) - 663-W0078-A0-00

Kit Includes:

Qty	Description	Part #
1	Gasket, Water Pump	66344315A000
1	Insert, Cartridge	663443220000
1	Outer Plate, Cartridge	663443230000
1	Gasket, Cartridge	66344324A000
1	Damper, Water Seal 2	663443660000
1	Impeller	6H3443520000
1	Key, Woodruff	902800302400
2	Bolt	970800804500
2	Bolt	970800805500

C55 (92~94) - 663-W0078-01-00

Kit Includes:

Qty	Description	Part #
1	Insert, Cartridge	663443220000
1	Impeller	6H3443520000
1	Gasket, Water Pump	66344315A000
1	Outer Plate, Cartridge	663443230000
1	Gasket, Cartridge	66344324A000
2	Bolt	970950805500
2	Bolt	970950804500
1	Damper, Water Seal 2	663443660000
1	Key, Woodruff	9028003M0300

60, 70 (04~), C75, P75, C80, 90, B90, C90 (97~), E75 - 692-W0078-02-00

Kit Includes:

Qty	Description	Part #
1	Insert, Cartridge	688443220000
1	Impeller	688443520300
1	Gasket, Water Pump	68844315A000
1	Outer Plate, Cartridge	688443230000
1	Gasket, Cartridge	68844324A000
1	Gasket, Water Pump	68844316A000
1	O-Ring	932104604400
2	Bolt, With Washer	9011908M1300
2	Bolt, With Washer	9011908M1600
1	Key, Woodruff	9028004M0400

CV40 (90) - 6F5-W0078-A0-00

Kit Includes:

Qty	Description	Part #
1	Damper, Water Seal 2	663443660000
1	Insert, Cartridge	676443220000
1	Impeller	6F5443520000
1	Gasket, Water Pump	67644315A100
1	Outer Plate, Cartridge	676443230000
1	Gasket, Cartridge	67644324A100
1	Gasket, Water Pump	67644316A100
2	Bolt	970950805500
2	Bolt	970950804500
4	Washer	929900860000
1	Key, Woodruff	9028004M0000

C40 (91~97) - 679-W0078-A1-00

Kit Includes:

Qty	Description	Part #
1	Damper, Water Seal 2	663443660000
1	Insert, Cartridge	676443220000
1	Impeller	6F5443520000
1	Gasket, Water Pump	67644315A100
1	Outer Plate, Cartridge	676443230000
1	Gasket, Cartridge	67644324A100
1	Gasket, Water Pump	67944316A100
2	Bolt	970950805500
2	Bolt	970950804500
1	Key, Woodruff	9028004M0000

E48 (95~00) - 696-W0078-00-00

Kit Includes:

Qty	Description	Part #
1	Insert, Cartridge	663443224000
1	Impeller	6H3443520000
1	Gasket, Water Pump	66344315A000
1	Outer Plate, Cartridge	670443230000
1	Gasket, Cartridge	66344324A000
2	Bolt	970950805500
2	Bolt	970950804500
1	Damper, Water Seal 2	663443660000
1	Key, Woodruff	9028003M0300

General
Information

Rigging Estimate
Guide (Diagrams)

Rigging
Components

Electrical
Components

Engine
Accessories

Propellers

Maintenance
Items

Oils
& Lubes

Detailing &
Trailer Supplies

Accessories
& Apparel

Generators
& Accessories

Maintenance Items

General Information

E60 (97~00) - 6K5-W0078-01-00

Kit Includes:

Qty	Description	Part #
1	Insert, Cartridge	663443224000
1	Impeller	6H3443520000
1	Gasket, Water Pump	6H344315A000
1	Outer Plate, Cartridge	6H3443234000
1	Gasket, Cartridge	6H344324A000
1	Gasket, Water Pump	68844316A000
1	O-Ring	932104604400
2	Bolt, With Washer	9011908M3300
2	Bolt, With Washer	9011908M1400
1	Key, Woodruff	9028003M0300

Rigging Estimate Guide (Diagrams)

Rigging Components

Electrical Components

60, C60, P60, 70, C70 (97~03) - 6H3-W0078-02-00

Kit Includes:

Qty	Description	Part #
1	Insert Cartridge	663443220000
1	Impeller	6H3443520000
1	Gasket, Water Pump	6H344315A000
1	Outer Plate, Cartridge	6H3443230000
1	Gasket, Cartridge	6H344324A000
1	Gasket, Water Pump	68844316A000
1	O-Ring	932104604400
2	Bolt, With Washer	9011908M1400
2	Bolt, With Washer	9011908M3300
1	Key, Woodruff	9028003M0300

Engine Accessories

Propellers

Maintenance Items

Oils & Lubes

C60, E60, P60, 70 (92~96) - 6H3-W0078-01-00

Kit Includes:

Qty	Description	Part #
1	Insert, Cartridge	663443220000
1	Impeller	6H3443520000
1	Gasket, Water Pump	6H344315A000
1	Outer Plate, Cartridge	6H3443230000
1	Gasket, Cartridge	6H344324A000
1	Gasket, Water Pump	68844316A000
1	O-Ring	932104604400
2	Bolt	970950804500
2	Bolt	970950805500
1	Key, Woodruff	9028003M0300

Detailing & Trailer Supplies

Accessories & Apparel

Generators & Accessories

C85 (91), CV85 (89~90), 90 (84~91) - 692-W0078-A0-00

Kit Includes:

Qty	Description	Part #
1	Gasket, Water Pump	68844315A000
1	Gasket, Water Pump	68844316A000
1	Insert, Cartridge	688443220000
1	Outer Plate, Cartridge	688443230000
1	Gasket, Cartridge	68844324A000
1	Impeller	688443520300
1	Key, Woodruff	9028004M0400
1	O-Ring	932104604400
2	Bolt	970950805000
2	Bolt	970950807000

E75 (95~96), P75 (96), C75 (94~96), C85, 90 (92~96) - 692-W0078-01-00

Kit Includes:

Qty	Description	Part #
1	Insert, Cartridge	688443220000
1	Impeller	688443520300
1	Gasket, Water Pump	68844315A000
1	Outer Plate, Cartridge	688443230000
1	Gasket, Cartridge	68844324A000
1	Gasket, Water Pump	68844316A000
1	O-Ring	932104604400
2	Bolt	970950805000
2	Bolt	970950807000
1	Key, Woodruff	9028004M0400

115, C115, 130 (~92) - 6E5-W0078-A1-00

Kit Includes:

Qty	Description	Part #
1	Gasket, Water Pump	6E544315A000
1	Insert, Cartridge	6E5443220000
1	Outer Plate, Cartridge	6E5443230000
1	Impeller	6E5443520100
4	Washer	9020908M0200
1	Key, Woodruff	9028004M0500
1	O-Ring	9321037M6700
1	O-Ring	9321086M3800
2	Pin, Dowel	936061201900
4	Bolt	970800804500

**115, C115, P115, S115 (96~99),
130 (93~96) - 6N6-W0078-00-00**

Kit Includes:

Qty	Description	Part #
1	Insert, Cartridge	61A443220000
1	O-Ring	9321086M3800
1	O-Ring	9321037M6700
1	Impeller	6E5443520100
1	Outer Plate, Cartridge	6E5443230000
1	Gasket, Water Pump	6E544315A000
1	Pin, Dowel	936061201900
4	Bolt	973950804500
4	Washer	9020908M0200
1	Key, Woodruff	9028004M0500

115, C115 (97~) - 6N6-W0078-02-00

Kit Includes:

Qty	Description	Part #
1	Insert, Cartridge	61A443220200
1	O-Ring	9321086M3800
1	O-Ring	9321037M6700
1	Impeller	6E5443520100
1	Outer Plate, Cartridge	6E5443230000
1	Gasket, Water Pump	6E544315A000
2	Pin, Dowel	936061201900
4	Bolt, With Washer	9011908M1400
1	Key, Woodruff	9028004M0500

150, P150, 175, 200, 225 (~91) - 6G5-W0078-A1-00

Kit Includes:

Qty	Description	Part #
1	Gasket, Water Pump	6E544315A000
1	Insert, Cartridge	6E5443220000
1	Impeller	6E5443520100
1	Outer Plate, Cartridge	6G5443230000
4	Washer	9020908M0200
1	Key, Woodruff	9028004M0500
1	O-Ring	9321037M6700
1	O-Ring	9321086M3800
1	Pin, Dowel	936061201900
4	Bolt	970800804500

Maintenance Items

D150, DX150, B115 (97~99) - 65N-W0078-A1-00

Kit Includes:

Qty	Description	Part #
1	Insert, Cartridge	61A443220200
1	O-Ring	9321086M3800
1	O-Ring	9321037M6700
1	Impeller	6E5443520100
1	Outer Plate, Cartridge	65N443230000
1	Gasket, Water Pump	65N44315A000
1	Key, Woodruff	9028004M0500
2	Pin, Dowel	936061201900
4	Bolt, With Washer	9011908M1400

**P150 (92~96), P175 (94~96), P200 (91~96),
C150 (96), 150~225 (96), L150~L250 (96),
S150~S250 (96) - 61A-W0078-A1-00**

Kit Includes:

Qty	Description	Part #
1	Insert, Cartridge	61A443220000
1	O-Ring	9321086M3800
1	O-Ring	9321037M6700
1	Impeller	6E5443520100
1	Outer Plate, Cartridge	6G5443230000
1	Gasket, Water Pump	6E544315A000
2	Pin, Dowell	936061201900
4	Bolt	970950804500
4	Washer	9020908M0200
1	Key, Woodruff	9028004M0500

**VZ200 (3.1L),
VZ225~VZ300 (03~) - 60X-W0078-00-00**

Kit Includes:

Qty	Description	Part #
1	Insert, Cartridge	61A443220200
1	O-Ring	9321086M3800
1	O-Ring	9321037M6700
1	Impeller	6E5443520100
1	Outer Plate, Cartridge	60X443230000
1	Gasket, Water Pump	60X44315A000
2	Pin, Dowel	936061201900
4	Bolt, With Washer	9011908M1400
1	Key, Woodruff	9028004M0500

General Information

Rigging Estimate Guide (Diagrams)

Rigging Components

Electrical Components

Engine Accessories

Propellers

Maintenance Items

Oils & Lubes

Detailing & Trailer Supplies

Accessories & Apparel

Generators & Accessories

Maintenance Items

Select Yamaha Item # to Open with the PPT ONLINE STORE

General Information

225,250 (92~), S150, SX150, S200, SX200, S250, SX250, V150~V250, VX150~VX250, VZ150~VZ200 (2.6L), Z150~Z300, P150~P200, C150 (97~99), PX150 (99) - 61A-W0078-A3-00

Rigging Estimate Guide (Diagrams)

Kit Includes:

Qty	Description	Part #
1	Insert, Cartridge	61A443220200
1	O-Ring	9321086M3800
1	O-Ring	9321037M6700
1	Impeller	6E5443520100
1	Outer Plate, Cartridge	6G5443230000
1	Gasket, Water Pump	6E544315A000
2	Pin, Dowel	936061201900
4	Bolt, With Washer	9011908M1400
1	Key, Woodruff	9028004M0500

Rigging Components

Electrical Components

Engine Accessories

Propellers

Maintenance Items

Oils & Lubes

Detailing & Trailer Supplies

Accessories & Apparel

Generators & Accessories

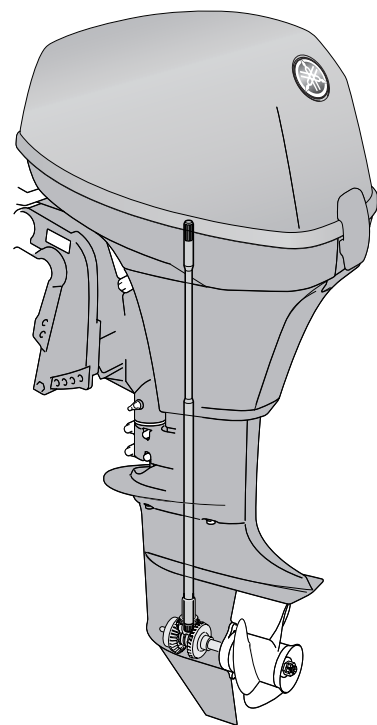

Don't forget the WR No. 2 grease for the driveshaft splines when reinstalling the lower unit after water services.



WR No. 2 Grease

Provides water resistance, rust protection, lubrication and heat resistance. Specially designed for four stroke oil pump seals, drive shaft splines and drive shaft bushing area. For four stroke and two stroke applications.

90790-74046-00